

# MS6D 6LED+6LED DUAL COLOUR LIGHTHEAD

## Surface Mount

To Chassis Ground:.....**BLACK**

To+VDC for **COLOUR 1** (fuse @ 2A):.....**RED**

To+VDC for **COLOUR 2** (fuse @ 2A):.....**WHITE**

(To+VDC for **COLOUR 1 2** alternating:..**RED+WHITE**)

For Synchronization and

Flash Pattern:.....**YELLOW**

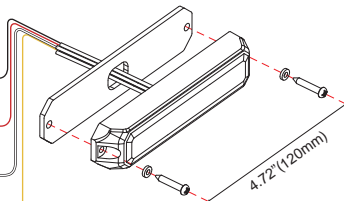

For Synchronization:

Connect **YELLOW** wires of all heads together for synchronization  
(All heads should be set at the same Flash Pattern)

For Simultaneous or Alternating Flash:

1. Apply +VDC to **RED**(or **WHITE**) and **YELLOW** wires simultaneously to enter Grouping mode; lighthouse will display short (single or double) flashes:
  - Single flash = Group1      • Double flash = Group2
2. Remove **YELLOW** wire from +VDC and momentarily apply to +VDC to change Groups:
  - Heads in the same Group flash together.
  - Group1 Heads alternate with Group2 heads.

For Flash Pattern, momentarily apply +VDC to **YELLOW** wire:

- once for next pattern
- quickly three times for reset to FP#1 (see flash pattern chart)

**NOTE:** This unit may not be factory-set at Flash Pattern #1

**Flash Patterns**

1	Random	7	Quad (SAE)
2	Steady	8	Quint (SAE)
3	Single (SAE)	9	8-Flash (SAE)
4	Mega	10	Single-Quad
5	Double (SAE)	11	Single H/L
6	Triple (SAE)	12	Single-Triple-Quint

# MS6D 6LED+6LED DUAL COLOUR LIGHTHEAD

## Adhesive Mount

1. Select a mounting location and clean the surface.
2. Peel one side of the adhesive and apply to the lighthouse base.
3. Peel the other side of the adhesive and secure the head firmly to the surface.

**NOTE:** Optimum adhesive strength is achieved after 24hrs.

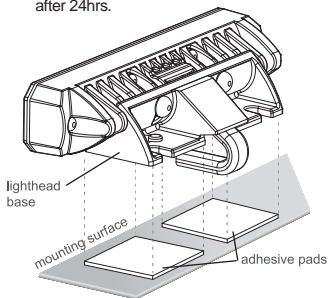

## Screw Mount

1. Select a mounting location for the lighthouse.
2. Mark and drill mounting holes.
3. Place the rubber pad to the bottom of the base.
4. Secure the head to the mounting surface with supplied screws.

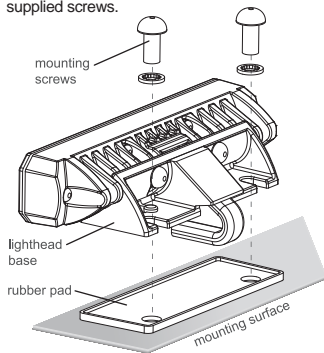

## Bracket Mount

1. Select a mounting location for the lighthouse.
2. Place the rubber pad to the bottom of the base.
3. Place the head to the mounting surface.
4. Align top holes of the bracket onto the lighthouse base alignment points.
5. Secure the head with supplied screws from the bottom of the bracket.

