

SL157 Exterior Scene Light Manual

WIRING:

To -Chassis Ground.....**BLACK**

To +VDC for Activation.....**RED**

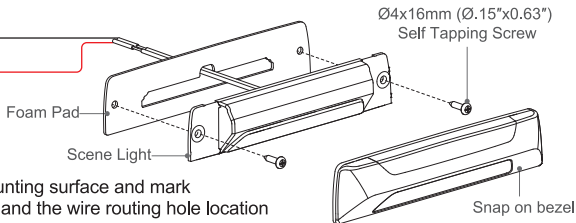

INSTALLATION:

1. Place the foam pad onto the desired mounting surface and mark the location for the two mounting screws and the wire routing hole location between the two screw holes.
 2. Drill two pilot holes for the two Ø4x16mm (Ø.15"x0.63") self tapping Screw and one Ø14 (Ø.55") wire routing hole.
- Note:** Deburr the wire routing hole thoroughly before feeding the wire.
3. Feed the wires through the foam pad and wire routing hole and mount the scene light with the supplied self tapping screws.
 4. Mount the snap on bezel onto the scene light.

MOUNTING DIMENSIONS:

