

# TLED04

## 4 LED Warning Lamp



### FEATURES

- Meet ECE R65 Class 1, R10 and SAE Class 1.
- Built-in 23 selectable flash patterns.
- Non-volatile memory recalls last flash pattern used at power up.
- Multi-unit synchronization in simultaneous or alternating flash.
- Reverse polarity protection.
- Weatherproof and vibration resistant design for external use.
- Solid aluminum base for efficient heat dissipation and maximum durability.

### SPECIFICATIONS

**Compliance:** ECE R65 Class 1 (XA1, XB1), ECE R10, SAE J595 Class 1, CA13, IP67

**LED Elements:** 1W LED x 4 pcs

**No. of Warning Patterns:** 23

**Operating Voltage:** 12~24VDC

**Avg. Current:** 0.29A @12VDC / 0.15A @24VDC  
(varies with flash pattern)

**Avg. Power:** 3.4W (varies with flash pattern)

**Max. Current:** 0.57A @12VDC / 0.29A @24VDC

**Max. Power:** 6.8W

**Wires:** Red-Vcc: 21cm (20AWG)  
Black-GND: 21cm (20AWG)  
Yellow-Flash Patterns & Sync: 21cm (20AWG)  
White-Phase: 21cm (20AWG)

**Fuse Rating:** 1A

**Synchronization:** up to 20 units

**LED Colour:** Red, Blue, Amber, White

**Lens Colour:** Clear

**Storage Temperature:** -40°C to +75°C

**Operating Temperature:** -40°C to +65°C

### DIMENSIONS

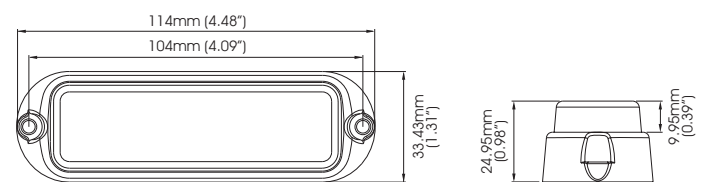

### FLASH PATTERN

FP#	Flash Pattern			
1	Single	[2Hz]	13	Single H/L (split)
2	Double	[2Hz]	14	Single
3	Triple	[2Hz]	15	Double
4	Quad	[2Hz]	16	Quad
5	Random		17	Quint
6	Single (split)		18	Mega
7	Double (split)		19	Ultra
8	Quad (split)		20	Single-Quad
9	Quint (split)		21	Single H/L
10	Mega (split)		22	Steady 2 (half)
11	Ultra (split)		23	Steady 4
12	Single-Quad (split)			

### PART NO.

- M036-1x03y-000 (SAE)
- M036-4x03y-000 (ECE R10)
- M036-3x03y-000 (ECE R65)

#### Replace x for base:

B = Black Base  
C = Chrome Base

#### Replace y for color:

A = Amber      B = Blue      R = Red      W = White  
Q = Red/Blue      J = Red/Amber \*      U = Red/White \*  
D = Blue/Amber \*      T = Blue/White \*      K = Amber/White  
\* MOQ = 50pcs

### ACCESSORY

- 99-M011X00-000 (Rubber Boot)
- 99-M036X00-000 (Rubber Boot)