

LED BEACON

Permanent Mount

WIRING

RED: To +VDC for Cruise Mode

BLACK: To Chassis Ground (-)

RED + WHITE: To +VDC for Warning Mode

YELLOW: Flash patterns & Synchronization

Connect **YELLOW** wires of all unit together for synchronization.
(All unit should be set to the same Flash Pattern)

OPERATION

For Flash Pattern Selection:

While activating a warning mode, momentarily apply **YELLOW** wire to +VDC:

- Once to next pattern
- Quick three times to FP#1
(refer to Flash Pattern Chart)

For Simultaneous or Alternating Synchronization:

1. Enter **SETTING MODE** by powering up with **YELLOW** and **RED** wires simultaneously, then remove **YELLOW** wire from +VDC.

The beacon will display short flashes:

- Single flash = Group 1
- Double flash = Group 2

2. Momentarily apply **YELLOW** wire to +VDC to change Groups:

- Lighthoods of the same Group will flash together.
- Lighthoods of the different Group will flash alternately.

3. Save and exit **SETTING MODE** by disconnecting all power.

FP#	FLASH PATTERNS	
1	Double	[R65]
2	Single	[2Hz]
3	Quad	[2Hz]
4	Single	[SAE]
5	Double	[SAE]
6	Quad	[SAE]
7	Quint	[SAE]
8	Mega	
9	Ultra	[SAE]
10	Single-Quad	
11	Single H/L	
12	Single Column Rotator	
13	Double Column Rotator	
14	Double Rotator x5 -> Quint x5	

Note: Actual approval will be based on model ordered.

1. Open beacon

Push down on Tab **1**, and twist the dome counterclockwise **A**, then lift the dome to open.

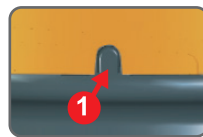

2. Change pattern

While activating Warning Mode, momentarily push the **RED BUTTON 2** to change to the next flash pattern.
(See Flash Pattern Chart)



3. Close beacon

Align dome indent **3** before Tab **1**, then twist clockwise **B** to close.

