

Mini Stealth

R65 Class II / Class I

6-LED Directional Warning Lamp (Surface Mount / Hood Mount)

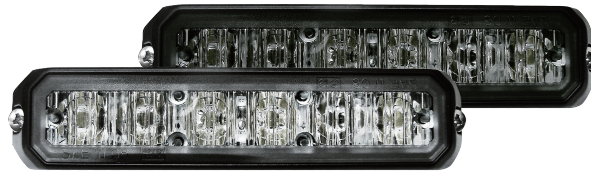

Horizontal Type

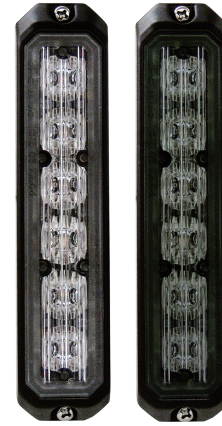

Vertical Type

► Now available in Smoked Lens!

FEATURES

- ECE R65 Class 2 (XA2, XB2) certified super high power output. Documentation available upon request.
- Smoked lens makes your MS6 warning light less conspicuous for blue “unmarked” application of law enforcement vehicles.
- Super low profile discreet mounting.
- Available in Horizontal and Vertical mount optics.
- Hood mount with Up/Down Angle adjustable.
- 12-24VDC Multi-Voltage Input.
- Non-volatile memory recalls last flash pattern used at power up.
- Multi-unit synchronization in simultaneous or alternating flash.
- Reverse polarity protection.
- Weatherproof and vibration resistant design for external use.
- Aluminum base for efficient heat dissipation and maximum durability.
- Meets ECE R65 Class 2 (XR2) standard. Certification will be applied upon request.

SPECIFICATIONS

Compliance: ECE R65 (XA2, XB2, XA1, XB1, XR1) / Clear Lens;
ECE R65 (XB1) / Clear Lens; Blue Lens; Smoked Lens;
ECE R10

LED Elements: High-power LED x 6 pcs

No. of Warning Patterns: 5

Operating Voltage: 12~24VDC

Hood Mount Wires: Red-Vcc: 97cm (20AWG)
Black-GND: 97cm (20AWG)
Yellow-Flash Patterns & Sync: 97cm (20AWG)
White-Low Power: 97cm (20AWG) *

Surface Mount Wires: Red-Vcc: 20cm (20AWG)
Black-GND: 20cm (20AWG)
Yellow-Flash Patterns & Sync: 20cm (20AWG)
White-Low Power: 20cm (20AWG) *

*Available only for ECE R65 Class 2 models.

Fuse Rating: 2A

Synchronization: Up to 15 units

Storage Temp. (°C): -40° ~ +75°

Working Temp. (°C): -30° ~ +65°

LED Color: Amber, Blue, Red, White

Lens Color: Clear, Blue, Smoked

Approval Lens	Specs (Max./Avg.)	XA1/XR1	XB1	XA2/XB2
Clear or Blue	Power	9.6W/4.8W	13.8W/6.9W	14.2W/7.1W
	Current @12VDC	0.80A/0.40A	1.15A/0.58A	1.18A/0.59A
	Current @24VDC	0.40A/0.20A	0.58A/0.29A	0.59A/0.29A
Smoked	Power		11W/5.5W	
	Current @12VDC		0.92A/0.46A	
	Current @24VDC		0.46A/0.23A	

DIMENSIONS

Hood Mount

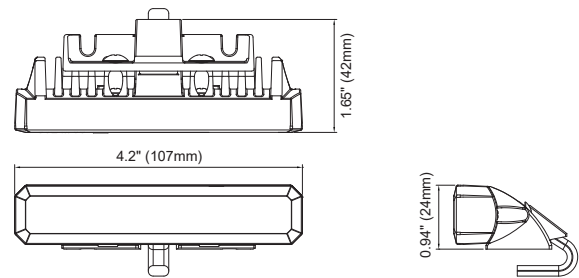

Surface Mount

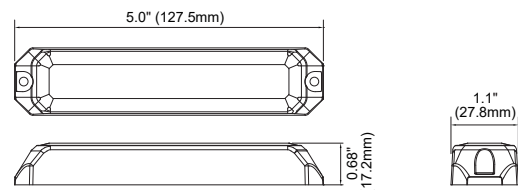

PART No.

M029 (Hood Mount) **M030** (Surface Mount)

R65 Class 2 Compliance

- **M029-x123y-000**
- **M030-x123y-000**

R65 Class 1 Compliance

- **M029-x113y-000**
- **M030-x113y-000**
- **M029-x133y-000** (Smoked Lens)
- **M030-x133y-000** (Smoked Lens)

R10 Compliance

- **M029-x103y-000**
- **M030-x143y-000** (Smoked Lens)

Replace x for optics:

0 = Horizontal optics
1 = Vertical optics

Replace y for color:

A = Amber LED (Clear Lens Only)
R = Red LED (Clear Lens Only)
B = Blue LED
2 = Blue LED (Blue Lens Only)
W = White LED

FLASH PATTERNS

Flash Patterns				
1	Single	[2Hz]	4	Quad [2Hz]
2	Double	[R65]	5	Steady
3	Triple	[2Hz]		

